

Tubular Solenoid

Linear - Pull - SDT 3050L



NSF
Innovative solutions
for a changing world

Dimensions

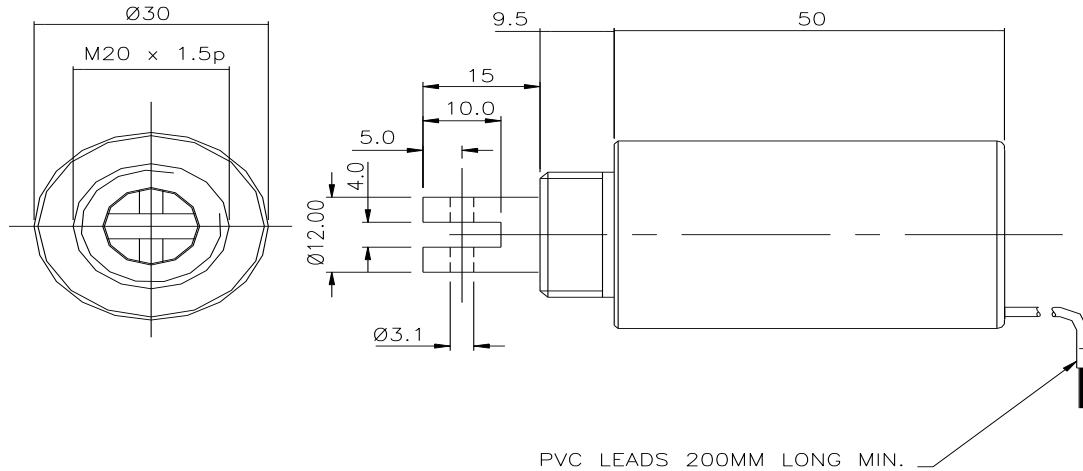

Solenoid shown in energised position

General Specifications

Dielectric Strength: 1000 VRMS

Coil Resistance: +/- 5% tolerance

Holding Force: 56.6 N @ 20° C

Weight: 230 g

Plunger Weight: 50 g

Recommended Heat Sink: Maximum watts dissipated by the solenoid are based on an unrestricted flow of air at 20° C mounted on the equivalent of an aluminium plate 102 x 102 x 3.2mm min.

Performance Specifications

Typical Starting Force @ 20° c

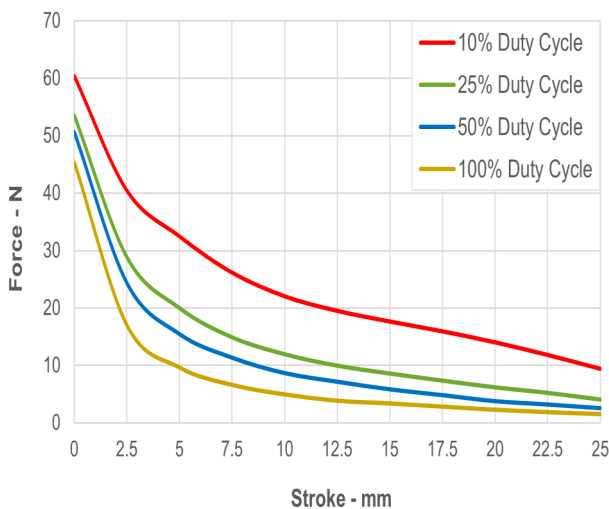

Coil Specifications

Maximum Duty Cycle	100%	50%	25%	10%		
Maximum ON Time (seconds) when pulsed continuously	∞	370	45	12		
Maximum ON Time (seconds) for single pulse	∞	480	135	38		
Watts (@ 20° C)	12	24	48	120		
Ampere Turns (@ 20° C)	1460	2070	2920	4600		
Coil Data						
avg.	Resistance (@ 20°C)	# Turns	Nominal DC Voltage			
23	3	745	6	8.5	12	19
26	12	1443	12	17	24	38
29	48	2927	24	34	48	76

Other ratings available on request

NSF Controls reserves the right to amend specification without prior notice. (Rev 08/21) www.nsfcontrols.co.uk

NSF Controls Ltd | Ingrow Bridge Works | Keighley | West Yorkshire | BD21 5EF | UK | E: info@nsfcontrols.co.uk | T: +44(0)1535 661144