

Size 6ECM Low Profile Solenoid



Push and Pull Linear

Medium Stroke, Conical Face

Part No: 282352-0XX

- **Dielectric Strength:** 23-31 awg. 1200 VRMS / 32-33 awg. 1500 VRMS
- **Recommended Heat Sink:** Maximum watts dissipated by the solenoid are based on an unrestricted flow of air at 20°C mounted on the equivalent of an aluminium plate 314x314x3.2mm min

Solenoid shown in energised position

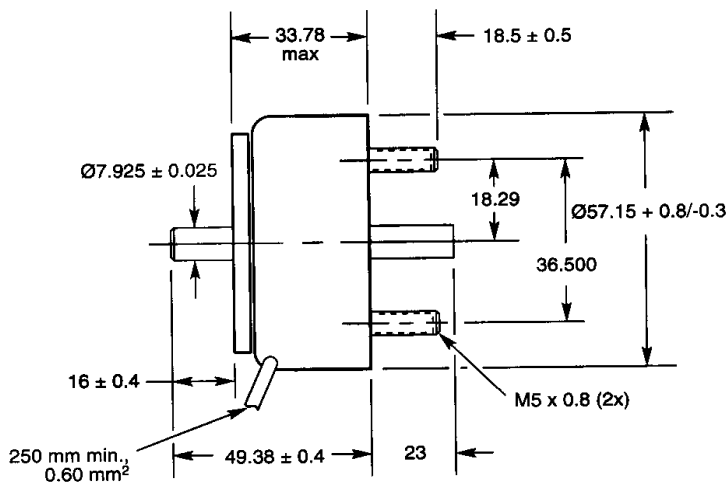

General Specifications:

- **Coil Resistance:** 23-33 awg. +/- 5% tolerance
- **Holding Force:** 218.0 N @ 105 °C
- **Weight:** 609.5 g
- **Typical Performance Details for 6E Series:**
 - Up to 318 N force at 0.5 mm stroke
 - Under 8 milliseconds response time for 1 mm stroke under no load conditions
 - Conical pole face allows increased stroke with minimal reduction in performance
 - Pull or push design

Notes

1. Continuously pulsed at stated watts and duty cycle
2. Single pulsed at stated watts (with coil at ambient room temperature 20°C)
3. Other coil gauges available, consult factory
4. Reference number of turns
5. Anti rotational mounting bushes available on request

Performance Specification

Typical Starting Force @ 20°C

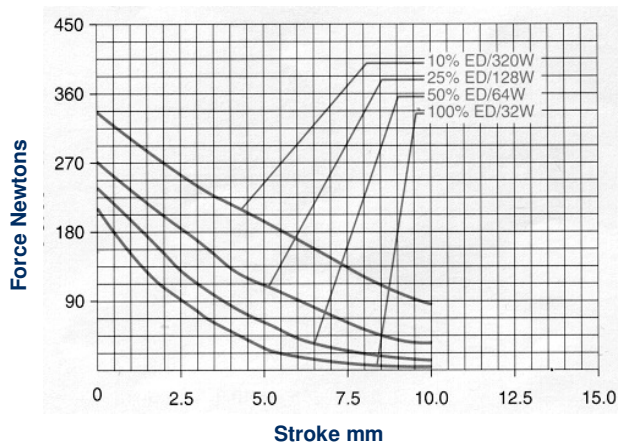

How to Order

Add the coil awg. number to the part number, alternatively please specify:

- Voltage
- Duty Cycle
- Starting Force
- Stroke Required
- Any Special Requirements

Coil Specifications

Maximum Duty Cycle	100%	50%	25%	10%
Maximum ON Time (seconds) When pulsed continuously (1)	∞	87	36	13
Maximum ON Time (seconds) for single pulse (2)	∞	140	44	16
Watts (@20°C)	32	64	128	320
Ampere Turns (@ 20°C)	1480	2080	2940	4620

Coil Data

awg. (0XX) (3)	Resistance (@ 20°C)	# Turns (4)	Nominal DC Voltage			
23	4.69	567	12.3	17.2	24.0	38.0
24	7.43	710	15.5	22.0	31.0	48.0
25	12.90	960	19.9	28.0	39.0	62.0
26	19.70	1170	25.0	35.0	49.0	78.0
27	32.00	1500	32.0	44.0	63.0	99.0
28	51.60	1904	40.0	56.0	79.0	125.0
29	74.40	2232	49.0	69.0	98.0	154.0
30	126.00	2940	63.0	89.0	126.0	198.0
31	195.00	3611	80.0	112.0	159.0	250.0
32	288.00	4350	98.0	138.0	195.0	306.0
33	427.00	5010	126.0	177.0	251.0	394.0

Please Note: In line with continued development we reserve the right to amend specification without prior notice (Rev 01/12)

NSF Controls Ltd | Ingrow Bridge Works | Keighley | West Yorkshire | BD21 5EF | UK | Registered in England No. 3378269

T: +44 (0) 1535 661 144 | F: +44 (0) 1535 661 474 | E: info@nsfcontrols.co.uk | www.nsfcontrols.co.uk